

Reference No. QCI/0421/035

**Request for Proposal for
Interior and Civil Works at Quality Council of India
Head Office**



Quality Council of India (QCI),
Institution of Engineers Building,
2nd Floor, 2, Bahadur Shah Zafar Marg,
New Delhi-110002

Tender Notice

1. Quality Council of India invites proposals for “**Interior and Civil Works at Quality Council of India Head Office**”
2. The content of this RFP enlists the requirements of Quality Council of India. It includes the Bidding Terms which details out all that may be needed by the potential bidders to understand the financial terms and bidding process and explain the contractual terms that the Quality Council of India wish to specify at this stage.
3. After the submission of the proposal according to the instructions provided in the sections below, the bids will be evaluated through a two-bid system.
4. The Documents to be submitted:

Form 1	Covering letter with the Proposal in response to RFP Notice
Form 2	Relevant Work Experience
Form 3	Resource Profiles
Form 4	Details of Responding Organization
Annexure - A	Bill of Quantities (BOQ)

5. The Proposal may be submitted at the following address on or before 30th April, 2021 by 5 pm via post to:
Deputy Director (Accounts), Quality Council of India (QCI)
2nd Floor, ICCW Building,
4-Deen Dayal Upadhyaya Marg
New Delhi - 110002, India

Tender Summary

#	Item	Details
1	Project Scope	Interior and Construction Work
2	Time for Completion	03 Months
3	Defects Liability Period	12 Calendar Months
3	Bid Selection	Two – Bid System
4	Payment	<p>Advance Payment: 10% of the total Job Value shall be released with confirmed work order</p> <p>First Running Bill: 30% of the total job value shall be released after 30% of the work done</p> <p>Second Running Bill: 30% of the total job value shall be released after 80% of the work done</p> <p>Third Running Bill: 20% of the total job value on completion of the job</p> <p>Fourth Running Bill: 5% of the of the total job value after handover</p> <p>Retention Amount: 5% after twelve(12)Calendar months on completion of the defect liability periods.</p>
5	Earnest Money Deposit	Not Applicable
6	Tender Advertisement Date	Saturday, 10 th April, 2021
7	Last Day and Date of Submission Of Bid	Friday, 30 th April 2021
8	PBG	3% of the Project Value
9	Estimated Budget	INR 1.2 Cr
10	Presentation Round	To be notified via E-mail

1. INTRODUCTION

1.1. Quality Council of India (QCI)

The Quality Council of India (QCI) is a pioneering experiment of the Government of India in setting up organizations in partnership with the Indian industry. The mandate of QCI is to lead nationwide quality movement in India by involving all stakeholders for emphasis on adherence to quality standards in all spheres of activities primarily for promoting and protecting interests of the nation and its citizens. To achieve this, QCI is playing a pivotal role in propagating, adoption and adherence to quality standards in all important spheres of activities including education, healthcare, environment protection, governance, social sectors, infrastructure sector and such other areas of organized activities that have significant bearing in improving the quality of life and well-being of the citizens of India.

2. Scope of Work and Deliverables for the Vendor

2.1. Scope of Work

The scope of work covered in this tender shall be as per the BOQ, specifications, drawings, instructions, orders issued to the vendor from time to time during the execution of work. The total area where the work needs to be undertaken is 3250 ft approx.

2.2. Deliverables and Timelines

1. **The Contract Period:** The Contract period shall be reckoned from the seventh (7th) day of issue of Work Order. The completion of the contract shall be date of issue of completion certificate. The commencement date for Defect Liability Period is the completion of Contract period.
2. **The Construction Period:** The Construction Period shall be **03 Months** from the commencement date. The completion date shall be the date of completion of the works at the end of the construction period including any extensions granted and taking care of snag list.
3. **Defects Liability Period:** The Defect Liability Period (Maintenance Period) shall be **12 calendar months** starting from the date of issuance of the Completion Certificate. The Contractor shall promptly repair or rectify all Defects and deficiencies observed by the QCI Authorised Person during the Defects Liability Period within a period of 15 (fifteen) days from the date of notice issued by QCI Authorised Person, in this behalf, or within such reasonable period as may be determined by the QCI Authorised Person at the request of the Contractor. The scope of work during the Defects Liability Period includes regular maintenance of the constructed facility including painting/polish finishes and electrical fittings in good condition. The costs of making good all these defects shall be borne solely by the Contractor and deemed to be included in the rates quoted by Contractor. If the contractor does

not rectify the defect or make good the deficiency, the work should be redone or rectified through another agency, or departmentally by employing skilled labourers, at the contractor's cost. The amount shall be deducted from any monies due to the contractor or realization of any Bank guarantee.

3. Terms of Engagement

3.1 Pre-Qualification Criteria

S. No	Basic Requirements	Specific Requirements	Documents Required
a.	Legal Entity	The Applicant should be a company registered in India under the Companies Act 2013 or any other previous Companies Act or a Limited Liability Partnership registered under the LLP Act, 2008 or a registered Partnership under the Indian Partnership Act, 1932*or. Registered as a society under the societies Act, 1860 for at least 10 (Ten) years, preceding the date of submission of bid.	- Copy of valid Registration Certificates - Copy of Certificates of incorporation
b.	Turnover	Average Annual Turnover of the Bidder during the last Three financial years, i.e. FY 2017-18, FY 2018-19, 2019-20 (as per the last published audited balance sheets), should be more than Rs. 1.50 Cr	Audited Annual Reports OR Balance Sheets or CA Certificate with CA's Registration Number/ Seal
c.	Technical Capability & Experience	The Applicant shall have completed at least three projects for Interiors & Civil Works or Interiors allied works of contract value of at least minimum Rs. 50 lakhs each during the past 3 years for the similar scope of work and at least one order value of Rs. 1.25 Cr during the past 3 years.	Work Order / Work Completion Certificates from the client
d.	Tax Registration	The company shall hold valid GST, PAN and PF and ESI registration	Copies of relevant certificates of registration
e.	Blacklisting	The bidder shall not have been blacklisted by any central or state government agency, PSU etc	Undertaking in this regard to be submitted.

4. Bid Evaluation and Selection Process

Overall evaluation of the bids will be done in two stages namely Technical and Financial evaluation.

4.1. Proposal Submission Guidelines

All vendors shall mark the below title in bold on all submissions and their company name with address clearly mentioned at the bottom right corner of the cover. BID Submission for RFP: “**Interior and Civil Works at Quality Council of India Head Office**”. Also mention on top of the sealed envelope, the nature of the document “**Technical Proposal**” or “**Financial Proposal**”.

4.1.1 Technical Proposal

The Technical Proposal (**one hard copy**) shall be submitted with the following:

1. Pre-Qualification Documents (as per the Pre-Qualification Criteria clause)
2. Technical Documents:
 - i. Form - 1
 - ii. Form - 2
 - iii. Form - 3
 - iv. Form - 4

4.1.2 Financial Proposal

The Proposal should be signed by the authorized signatory and submitted in a sealed envelope, only as a hardcopy, separate from the Technical proposal. Softcopies are not permissible. The Proposal must adhere to the following guidelines:

1. The Vendors should submit the proposal as per the format given in Annexure - A

Taxes would be additional and as per applicable statutory norms.

4.2. General Terms and Conditions

The Vendor for this engagement would be selected through a competitive bid process, the details of which are provided below:

1. The QCI reserves to itself the authority to reject any or all the tenders received without assigning any reason. The acceptance of a tender shall be effective w.e.f. the date on which the telegram/ letter of intent of acceptance of the tender is put in the communication by the QCI. QCI also reserve the right to Split the work among two or more parties at lowest negotiated rate without assigning any reason thereof. The contractor is bound to accept the portion of work as offered by QCI after Split up at the quoted / negotiated rates.
2. **Mobilization of Men, Materials and Machinery:** All expenses towards mobilization at site and de-mobilization including bringing in equipment, work force, materials, dismantling the equipment, clearing the site etc. shall be deemed to be included in price quoted and no separate payment on account of such expenses shall be entertained. It shall be responsibility of

the contractor to obtain the approval for any revision and / or modification desired by him from QCI before implementation. Also such revision and/or modifications if accepted /approved by the QCI shall be carried at no extra cost to QCI. All materials, once bought by the contractor within the project area, will not be allowed to be removed from the premises without the written permission of the QCI.

3. The rates quoted by the tenderer shall be firm and fixed for the entire period of completion and till handing over of the work. No revision to rates or any escalation shall be allowed on account of any increase in price of materials, labour, POL and overheads etc or any other statutory increase during the entire contract period.
4. No claim on account of any price variation / Escalation on whatsoever ground shall be entertained at any stage of works. All rate as per BOQ quoted by contractor shall be firm and fixed for entire contract period as well as extended period for completion of the works. No escalation price variation clause shall be applicable on this contract.
5. **Employment of Personnel:** The contractor shall employ only Indian Nationals as his representatives, servants and workmen after verifying their antecedents and loyalty. He shall ensure that no personal of doubtful antecedents and any other nationality in any way is associated with the works. Contractor will need to submit an undertaking to this effect before start of works. QCI shall have full power and without giving any reason to the contractor, to immediately remove any representative , agent, servant and workmen or employee on account of misconduct negligence or incompetence or whose continued employment may in their opinion be undesirable. The contractor shall not be allowed any compensation on this account.
6. **Technical Staff For Work:** The contractor shall employ at his own cost the adequate number of technical and other staff during the execution of this work depending upon the requirement of work. The contractor shall not be entitled for any extra payment in this regard. The technical staff should be available at site, whenever required by QCI for discussion and to take instructions.
7. **Work On Sundays, Holidays And During Night:** For carrying out work on Sunday and holidays or during night, the contractor will approach the QCI Authorised Person or his representative at least two days in advance and obtain his permission. The contractor shall have no claim on his account whatsoever. If work demand, the contractor shall make arrangement to carry out the work on Sundays, Holidays and in two, Three shifts with the approval of QCI Authorised Person at no extra cost to QCI.
8. **Rates to be Firm:** The rates quoted by the tenderer shall be firm and fixed for the entire period of completion and till handing over of the work. No revision to rates or any escalation shall be allowed on account of any increase in price of materials, labour, POL and overheads etc or any other statutory increase during the entire contract period.
9. **No Idle Charges Towards Labour:** No idle charges or compensation shall be paid for idling of the contractor's labour, staff etc. on any ground or due to any reason whatsoever. QCI will not entertain any claim in the respect.
10. **Work To Be Executed In Accordance With Specifications, Drawings, Orders Etc.:** The contractor shall execute the whole and every part of the work in the most substantial and workman like manner both as regard

materials and otherwise in every respect in strict accordance with the specification. The contractor shall also conform exactly, fully and faithfully to the design, drawings and instructions issued in respect to the work assigned by the QCI Authorised Person. The contractor shall comply with the provisions of the contract and execute the works with care and diligence and maintain the works and provide all labour and materials, tool and plants including for measurement and supervision of all works, structural plans and other things of temporary or permanent nature required for such execution and maintenance in so far as the necessity for providing these is specified or is reasonable inferred from the contract. The contractors shall take full responsibility for adequacy, suitability and safety of all the works.

11. **Presentation:** As a part of Evaluation of proposals submitted by the applicants, QCI reserves the right to seek further information or a presentation from the Organizations for evaluation purposes. QCI may call for such information/presentation at a short notice.
12. **Schedule of Rates:** The quantities shown against the various items of work are only approximate quantities which may vary as per the actual requirement / measurement at site.
13. **Materials and Samples:** The materials / products used on the work shall be of approved make/ brands out of list of approved makes given in the tender document. The contractor shall submit samples/ specimens of approved makes of materials / products to the QCI Authorised Person for prior approval. In exceptional circumstances QCI Authorised Person may allow alternate equivalent makes / brands of products / materials at his sole discretion. The final choice of brand/ make shall remain with the QCI Authorised Person, whose decision in the matter shall be final and binding and nothing extra on this account shall be payable to the contractor.
14. **Warranty:** The manufacturer warranty of all the items should be transferred to QCI as a part of the handover of the site.
15. **Care of Works:** From the commencement to the completion of the works handing over to the QCI and contractor shall take full responsibility for the care thereof and all temporary works and in case any damage loss or injury shall happen to the works or to any part thereof or to any temporary works due to lack of precaution / negligence on part of contractor, the same shall be made good at his own cost.
16. **Prohibition on Subletting :**The contractor shall not sublet or assign the whole or part of the works except where otherwise provided, by the contract and even then only with the prior written consent of QCI and such consent if given shall not relieve the contractor from any liability or obligation under the contract and he shall be responsible for the acts, defaults or neglects of any subcontractor, his agent, servants or workman as if they were the acts, the defaults or neglects of the contractor, his agent servants or workman provided always that the provision of labour on piece work basis shall not be deemed to be a subletting under this clause
17. **Compensation for Delay and Remedies:** If the contractor fails to maintain the required progress in terms of relevant clause of contract, to complete the work and clear the site on or before the Completion date or extended date of completion, he shall, without prejudice to any other right or remedy available under the law to the Govt. on account of such breach, pay as agreed compensation the amount calculated at the rate stipulated

below or such amount as the QCI Authorised Person (whose decision in writing shall be final and binding) may decide on the amount of tendered value of the work for every complete day /week (as applicable) that the progress work remains incomplete.

18. **Defects Liability Period:** The contractor shall be responsible for the rectification of defects in the works for a period **of 12 calendar months** from the date of taking over of the works by the Owner / Client. Any defects discovered and brought to the notice of the contractor shall be attended to and rectified, by the contractor at his own cost and expense. In case the contractor fails to carry out these rectifications, the same may without prejudice to any other right or remedy available, be got rectified by QCI at the cost and expense of the contractor.
19. Precautions to avoid any nuisance to the neighbourhood / surrounding. All the necessary precautions will need to be taken during the implementation of the project (either during day or night), to avoid any nuisance or any harm causing to the neighbourhood/surrounding areas of proposed construction site. No complaint should arise by the neighbourhood /occupiers of other office in the building, during the development work by contractor or any of the persons directly or indirectly related to the site work. In case of any such conditions the contractor shall be fully responsible for the consequences & settlement
20. **Authenticity of Equipment:** The selected bidder shall certify that the supplied goods are brand new, genuine/ authentic, not refurbished, conform to the description and quality as specified in this bidding document and are free from defects in material, workmanship and service. If during the contract period, the said goods be discovered counterfeit/ unauthentic or not to conform to the description and quality aforesaid or have determined (and the decision of the Purchase Officer in that behalf will be final and conclusive), notwithstanding the fact that the purchaser may have inspected and/ or approved the said goods, the purchaser will be entitled to reject the said goods or such portion thereof as may be discovered not to conform to the said description and quality. The selected bidder shall, if so called upon to do, replace the goods etc., or such portion thereof as is rejected by Purchase Officer, otherwise the selected bidder shall pay such damage as may arise by the reason of the breach of the condition herein contained. Nothing herein contained shall prejudice any other right of the Purchase Officer in that behalf under this contract or otherwise. Goods accepted by the purchaser in terms of the contract shall in no way dilute purchaser's right to reject the same later, if found deficient in terms of the this clause of the contract
21. **Contractor Liable For Damage Done and For Imperfections:** If the Contractor or his work people or servants shall break, deface, injure or destroy any part of a building in which they may be working or any building, road, fence, enclosure, or cultivated ground, contiguous to the premises on which the work or any part of it is being executed, or if any damage shall happen to the work. If any imperfection becomes apparent while the work is in progress, , or the contractor shall within a period specified by QCI after a Certificate, final or otherwise of its completion (given by the QCI Authorised Person or Tendering Authority), shall cause the same to be made good by other workmen and deduct the expense (of which the certificate of the QCI Authorised Person or Tendering Authority shall be

final) from any sums may be then, or at any time, thereafter that may become due to the Contractor, or form his performance security, or the proceeds of sale thereof, or of a sufficient portion thereof.

22. **Withdrawal of Work from the Contractor:** If the Tendering Authority shall at any time and for any reasons, whatever, including inability to maintain pro rata progress, think any portion of the work should not be executed or should be withdrawn from the contractor, he may by notice in writing to that effect, require the Contractor not to execute the portion of the work specified in the notice, or may withdraw from the Contractor the portion of work, so specified, and the Contractor shall not be entitled to any compensation, by reason of such portion of work having been withdrawn from him. The QCI Authorised Person or Tendering Authority may supplement the work by engaging another agency to execute such portion of the work at the cost of the original contractor without prejudice to his rights. He shall also be competent to levy penalty for delay in progress. The recovery of excess cost shall be made good from next available 3 running bill or any other claim and shall not be deferred.
23. **Protect Works:** The contractor shall arrange to protect, at his own cost, in an adequate manner all stone work and other works , requiring protection and to maintain such protection, as long as work is in progress. He shall remove and replace this protection as required by the QCI Authorised Person or Tendering Authority, from time to time, any damage to the work, so protected no matter how it may be caused. Shall be made good by the Contractor free of cost. All template , forms, moulds, centering, false ceiling works and models, which in the opinion of the QCI Authorised Person or Tendering Authority, are necessary for the proper and workman like execution of the work, shall be provided by the Contractor free of cost.
24. **Fair Wage Clause:** The contractor shall pay less than fair wages/minimum wages to labourers engaged by him on the work as revised from time to time by the Government but the shall not be liable to pay anything extra.
25. **Safety of Workers:** Ensuring safety of workers at time of construction shall be the responsibility of the bidder. QCI has no obligation or responsibility towards any individual in any such case or situations. The bidder must have and maintain valid and keep in force insurance policies accidents, public liability, professional indemnity, worker's compensation required by law. The bidder shall provide personal protective equipment like helmet, face shield, gloves, safety shoes, etc., of standard make acceptable, to all the employees at their cost.
26. **FORCE MAJEURE:** Any delay in or failure of the performance of either party hereto shall not constitute default hereunder to give rise to any claims for damages, if any to the Extent such delay or failure of performance is caused by occurrences such as acts of God or the public enemy , expropriation, compliance with any order or request of Government authorities, acts of war, rebellions, sabotage fire, floods, illegal strikes, or riots (otherwise than among the contractors employees). Only extension of time shall be considered for Force Majeure conditions as accepted by QCI. No adjustment in contract price shall be allowed for reasons of force majeure.
27. The contract will be awarded to the Vendor whose proposal conforms to the terms of the RFP and is, in the opinion of QCI, the most advantageous and represents the best value of the assignment, price and other factors

considered. QCI reserves the right to negotiate with the most competitive Vendor if required.

28. **COVID-19 Guidelines:** The bidder needs to ensure that all the personnel adhere to WHO and MHA COVID- 19 safety protocols at all the time during the construction period.
29. **Performance Bank Guarantee:** The Purchaser will require the selected Bidder to provide a Performance Bank Guarantee, within 30 days from the Notification of award, for a value equivalent to **3 % of the bid value**. The Performance Bank Guarantee shall contain a claim period of three months from the last date of validity. The selected Bidder shall be responsible for extending the validity date and claim period of the Performance Bank Guarantee as and when it is due on account of non-completion of the delivery and Warranty period. In case the selected Bidder fails to submit performance Bank guarantee within the time stipulated, the Purchaser at its discretion may cancel the order placed on the selected Bidder without giving any notice. Purchaser shall invoke the performance guarantee in case the selected Bidder fails to discharge their contractual obligations during the period or Purchaser incurs any loss due to Bidder's negligence in carrying out the project implementation as per the agreed terms & conditions.
30. **Ethics:** QCI expects all operators, shortlisted bidder(s) to show highest ethical standards during the course of the assignment especially during on-groundwork. If any complaints/information regarding any incident of malpractices (bribery, seeking monetary or non-monetary favor/gifts) is brought to the notice, the shortlisted bidder(s) shall take the necessary action (to the extent of expulsion/removal) as per its organization rules and laws applicable at that time. QCI is absolved of any liability/claim arising out of any such above situations.
31. **Insurance:** The Goods supplied under the Contract shall be fully insured against loss by theft, destruction or damage incidental to manufacture or acquisition, transportation, storage, fire, flood, under exposure to weather and delivery at the designated project locations, in accordance with the applicable terms. The insurance charges will be borne by the supplier and Purchaser will not be required to pay such charges if incurred. The goods will be delivered at the FOR destination in perfect condition.
32. **Plant, Machinery & Job facility Area:** The contractor will have to make his own arrangement for storage of materials, plants, equipment's, machineries to be used in the execution of this work well in time after award of the contract, at his own cost. The land for facilitating the works shall be arranged by the contractor and maintained and re-instated after the implementation as per Environment mitigation norms. The contractor shall allow the QCI Authorized persons or any person authorized by the local authorities to access the site or any place where work in connection with the contract is being carried out or intended to be carried out or to any place where materials or plant are being manufactured / fabricated/ assembled for the works.
33. **Liquidated Damages:** The work must be completed as stipulated in the acceptance of the tender should be deemed to be the essence of the contract and delivery must be completed no later than the dates specified therein. Extension will not be given except in exceptional circumstances. However, if the work is completed after expiry of the contracted completion

period without prior concurrence of QCI, such delivery will not deprive the purchaser of his right to recover liquidated damages.

34. **Confidentiality:**

The bidder(s) must not divulge any confidential information and ensure that reasonable steps are taken to provide for the safe custody of any and confidential information in its possession and to prevent unauthorized access thereto or use thereof. The shortlisted bidder(s) must not, without the prior written consent of QCI, disclose any confidential information of QCI or any government department or relating to any ministry or any other party. In giving written consent to the disclosure of confidential information, QCI may impose such conditions as it thinks fit, and the bidder must comply with these conditions. Confidentiality clause shall survive for a period of one year after the termination of contract or contract expiry period.

35. **Payment Milestones:**

- i. **Advance Payment:** 10% of the total Job Value shall be released with confirmed work order
- ii. **First Running Bill:** 30% of the total job value shall be released after 30% of the work done
- iii. **Second Running Bill:** 30% of the total job value shall be released after 80% of the work done
- iv. **Third Running Bill:** 20% of the total job value on completion of the job
- v. **Fourth Running Bill:** 5% of the of the total job value after handover
- vi. **Retention Amount:** 5% after months on completion of the defect liability periods.

36. **Penalty:** Penalty may be imposed on non-performance/ violation of any of the terms and conditions mentioned in this work order. The quantum of such penalty shall be as decided by the committee of officials (constituted by QCI). The following shall be the treatment in case of damages and delays:

- i. Any damage to the building or to any equipment which might result during the repair shall be repaired by the Contractor/ Service Provider.
- ii. If the job is not completed within the stipulated time penalty amount @ 1% (of the contract value) per day will be applicable on the contractor.

37. QCI reserves the right to accept or reject any bid, to annul the entire bid process or reject all bids at any time prior to award of contract, without thereby incurring any liability to the affected Vendor(s) or any obligation to inform the affected Vendor(s) the grounds for such decision. QCI also reserves the right to negotiate with the successful Vendor if necessary.

38. The contract will be awarded to the Vendor whose proposal conforms to this RFP and is, in the opinion of QCI, the most advantageous and represents the best value to the assignment, price and other factors considered.

39. No part of this document including the Annexure can be reproduced in any form or by any means, disclosed or distributed to any person without prior written consent of QCI, except to the extent required for submitting the bid and no more. The information contained in this document is only disclosed for the purposes of enabling potential Vendors to submit a proposal to QCI.

This document should not therefore be used for any other purpose. This document contains proprietary information furnished for evaluation purposes only; except with the written permission of the QCI, such information may not be published, disclosed, or used for any other purpose. The bidding firms acknowledge and agree that this document and all portions thereof, including, but not limited to, any copyright, trade secret and other intellectual property rights relating thereto, are and at all times shall remain the sole property of QCI. The title and full ownership rights in the information contained herein and all portions thereof are reserved to and at all times shall remain with QCI. Vendors must agree to take utmost care in protecting the proprietary and confidential nature of the information contained herein.

40. QCI, by issuance of this RFP does not necessarily indicate or imply that the project will be commenced. The Vendor will absolve QCI of all responsibilities if the project does not start within a stipulated timeframe. QCI reserves the right to withdraw this assignment any time without prior consultation or intimation to the Vendors.
41. The interested Vendors shall furnish an affirmative statement as to the existence of, absence of, or potential for conflict of interest on the part of the Vendor or any prospective subcontractor due to prior, current, or proposed contracts, engagements, or affiliations with QCI. Additionally, such disclosure shall address any and all potential elements (time frame for service delivery, resource, financial or other) that would adversely impact the ability of the Vendor to complete the requirements as given in the RFP.
42. The last date for pre-bid queries is 3 days before the date of the submission of the proposal.
43. The Vendor shall not make any alteration / changes in the bid after the closing time and date. Unsolicited correspondence from the Vendor will not be entertained.
44. If at any stage of the tendering process or during the currency of the agreement any suppression / misrepresentation of such information is brought to the knowledge of QCI, QCI shall have right to reject the bid or terminate the agreement, as the case may be, without any compensation to the Vendor.
45. The Vendor shall be deemed to have complied with all clauses in this RFP. Evaluation shall be carried out on the available information in the bid
46. The firms / agencies submitting their proposals would be responsible for all of its expenses, costs and risks incurred towards preparation and submission of their proposals, attending any pre-proposal meeting and visiting the site or any other location in connection therewith. QCI shall, in no case, be responsible or liable for any such costs whatsoever, regardless of the outcome of the process.
47. The proposals submitted by the firms/agencies shall remain valid for a period of two months after the closing date (deadline) for submission of proposals prescribed in this document.
48. During evaluation, QCI may, at its discretion, ask the respondents for clarifications on their proposals. The firms/agencies are required to respond within the time frame prescribed by QCI.
49. At any time prior to deadline for submission of proposals, QCI may for any reason, modify the RFP document. The prospective respondents having

received the RFP document shall be notified of the amendments through email and such amendments shall be binding on them.

50. QCI may at its sole discretion and at any time during the evaluation of proposal, disqualify any respondent, if the firm:
- i. Submitted the proposal after the response deadline
 - ii. Made misleading or false representations in the forms, statements and attachments submitted in proof of the eligibility requirements
 - iii. Exhibited a record of poor performance such as abandoning works, not properly completing the contractual obligations, inordinately delaying completion or financial failures, etc. in any project in the preceding three years
 - iv. Submitted a proposal that is not accompanied by required documentation or is non-responsive, failed to provide clarifications related thereto, when sought
 - v. Submitted more than one proposal
 - vi. Was declared ineligible by the Government of India/State/UT Government for corrupt and fraudulent practices.
51. QCI reserves the right to (a) reject any / all proposals without assigning any reasons thereof, (b) relax or waive any of the conditions stipulated in this RFP document as deemed necessary in the best interest of QCI and the objectives of the project without assigning any reasons thereof and (c) include any other item(s) in the Scope of work at any time after consultation.

5. Documents Submission

The following set of documents needs to be submitted to qualify for the evaluation process. These documents are:

1. Form 1: Covering letter with the Proposal in response to RFP Notice
2. Form 2: Relevant Project Experience
3. Form 3: Resource Profiles
4. Form 4: Details of responding organization
5. Annexure A: Bill of Quantities

All service providers shall mark the below title in bold on all submissions and their company name with address clearly mentioned at the bottom right corner of the cover. "Interior Works at Quality Council of India Head Office" Also mention on top of the sealed envelope, the nature of the document "Technical Proposal" or "Financial Proposal". The Technical and Financial Proposal should be signed by the authorized signatory and submitted in a sealed envelope, only as a hardcopy, both the proposals separately. Softcopies are not permissible.

For queries:

Email id: procurement@qcin.org

Email id: kanika.sethi@qcin.org

Annexure – A : Bill of Quantities (BOQ)
Summary

Sr#	Description	Unit	Qty. / Area
A	Area	Sq.Ft.	3250
1	Civil & Interior work	Sq.Ft.	3250
2	Plumbing work	Sq.Ft.	3250
3	Electrical & lighting work	Sq.Ft.	3250
4	Air Conditioning work (HVAC) (If Required)	Sq.Ft.	3250
5	Fire Detection System and Fire Extinguishers	Sq.Ft.	3250
6	Rodent Control	Sq.Ft.	3250
7	CCTV work	Sq.Ft.	3250
8	Access Control System	Sq.Ft.	3250
9	Loose furniture	Sq.Ft.	3250
10	Structural Repair	Sq. Ft	3250
11	Modular furniture and Chairs	Sq.Ft.	3250
	Total - A		
B	Design Consultancy Charges (For Detailed Design & Engineering with PMC)	Sq.Ft.	3250
	Total Project cost (A + B)		
	Total Project Cost (With Taxes)		

Civil & Interior Works					
Sr#	Description	Unit	Total Qty.	Rate	Amount
A	CIVIL & INTERIOR WORKS				
1	Providing General house keeping for Daily Clearance of unusable material and scrap from site. agency for general house keeping works of the site with all the consumable and accessories like mop, buckets, heavy duty vacuum cleaners - 1 nos. etc. House keeping team would be responsible for only general house keeping and monitored by Project Managers at site. Also needs to have professional house keeping team of 4 persons before 5 days of hand over and needs to be clean flooring, glass and all areas including requirement of manpower and materials.	L/S	1		
2	Dismantling brickwork/ tiles/ floorings etc manually/by mechanical means including stacking of serviceable material and disposal of unserviceable material outside the premises to nearest sanitary landfill site	SqM	500		
3	PCC	SqM	200		
4	12mm Cement Plaster : Providing and applying in one coat, 12mm thick plaster on internal and external surface of RCC / brick/block walls in cement mortar 1:6, finished rough to take on POP punning. Rate shall include for necessary scaffolding to any height, making grooves, sills, pattas, curing, surface preparation before the application of plaster, providing galvanized chicken mesh to a width of 150 mm at the junctions of masonry and concrete works including tying in position by using suitable nails / clamps / screws and as directed etc. complete at all levels. The contractor shall make good the grooves, pockets etc.	SqM	150		
5	POP Punning: Providing & applying average 12mm thick plaster of Paris and wire mesh at joints of diff materials to the walls and columns in square plumb line and level including scraping and removing the existing finish, hacking the surface of walls/columns. After levelling, the surfaces to be finished to receive paint etc. Rate to include providing for AI channels and grooves at all junctions and corners.	SqM	150		
B	JOINERY				
1	Frameless Glazed Partitions, Toughened				
	FULL HEIGHT FRAMELESS TOUGHENED GLAZED PARTITION: Fabricating and fixing of 10mm thk. Toughened Glass partitions with concealed fixing arrangement in floor & ceilings as per drawings/Technical specifications and as directed by QCI Authorised Person. The rate shall include sealing all joints with non staining clear silicon sealant, machine cut polished edges, tapers to design.	SqM	175		
2	75 mm Thk. Full Height Partitions with MDF on both Sides without any Panelling.	SqM	150		

	FULL HEIGHT PARTITION: Providing and fixing 75 mm thick partition faced both sides with 12 mm thick MDF/gypsum , screw fixed with dry wall s+B147crew of 25 mm at 300 mm centres to either sides of 48 mm GI studs (.55 mm thick), having one flange of 34 mm and other flange of 36 mm, placed at 610 mm centre to centre (both ways) in 50 mm floor and ceiling channels of 32 mm section. Skirting, door junction and material transition sections to be in hardwood frame 50 x 50 to provide 10x10 grooves at all ends. If any hardwood sections are provided, these are to be coated all over with 2 or more coats of viper anti-termite/fire retard paint. Inside voids to be filled with 50 mm thick panels of glass wool/ rock wool protected by layer of Tissue Paper. All edges to be protected with aluminium angles.				
3	100 mm Thk. Fire Rated Gypsum Partition				
	FIRE RATED PARTITION : Form full height Gypsum Partition with GI Channels and studs as per specifications of Item No. C 2 above but finished with 2 layers of 12 mm thick Fire Rated Gypsum Board on each side complete with jointing and taping.	SqM	15		
4	Fabric Panelling				
	FABRIC PANELING: P&F panelling over existing partition (Item No. C 2 above), formed of 12 mm thick Cellotex board wrapped in fabric. Fabric Shade as approved. Basic rate of Fabric : Rs. 200 per metre.	SqM	20		
5	Colour Back Glass Panelling				
	COLOR BACK GLASS PANELLING: Form panelling on existing partitions (Item No. C 2 above) with 4 mm thick Lacquered glass of approved make over 6 mm MDF/PLY. Backing Ply/MDF face to be painted with colour to match the glass. Glass to be fixed with dow corning/ 3M high bond tape of adequate bond strength, to laminated strips affixed to the backing ply.	SqM	5		
6	Laminated Panelling				
	LAMINATED PANELING: Form panelling on existing partition (Item No. C 2 above) with 12 mm thick fire retardant ply and finished with 1 mm thick laminate as per architect's approval including Providing for 10 mm x 10 mm grooves as required. Laminate Shade as approved.	SqM	20		
7	Wallpaper Panelling				
	WALLPAPER PANELLING: P&F Wall paper panelling over adequate levelled surface in approved design. Wall paper to have PVC coated paper backing. Minimum width of 70cm per roll. Total weight 400g/sqm. Base rate of wall paper Rs 175/sqft.	SqM	30		
8	Partitions above false ceiling				
	PARTITIONS ABOVE FALSE CEILINGS: Partitions as item above but entirely of GI frame and without skirting, to be installed over false ceilings.	SqM	25		
9	Pelmet	RM	20		

	PELMET: Fabricate and install pelmet made of 19 mm thick board, up to 300 mm high and in line with external glazing as per details of Architect. Rate to include finishing exposed surfaces of the Pelmet with enamel paint of approved shade. Pelmet to be ready to receive blinds.				
10	Recessed Pelmets for Screens	RM	5		
	RECESSED PELMET FOR SCREENS: As per item above but of width 250 mm and height 250 mm, cut into gypsum false ceilings and ready to receive projection screen.				
11	Window Cill	RM	25		
	WINDOW CILL: Fabricate and install 150 mm wide, window cill along external windows. Cill to be constructed out of 19 mm Commercial board, and faced with 1 MM thick Laminate as approved.				
C	BUILT IN STORAGE				
1	Full Ht. Storage: Laminated	SqM	15		
	FULL HEIGHT STORAGE, LAMINATED: Fabricating and fixing full height storage cupboards as per details. Top, bottom and shelves to be made out of 19 mm thick commercial board, back to be provided of 6 mm thick commercial ply, shutters to be made out of 19 mm thick commercial board faced with 1.00 mm thick laminate. All internal surfaces to be faced with 0.8 mm thick laminate of approved shade. External surfaces finished on exposed sides with 1 mm thick laminate. Complete with all necessary fittings like hinges, ball catchers, tower bolts, locks, handles, adjustable shelves etc. as per directions of Architect. Cupboard depth of 400-450 mm. Adjustable shelves to be supported on half cut; 10 mm dia s.s glass pins. Laminate as approved.				
2	Medium Ht. Storage: Laminated	SqM	20		
	MEDIUM HEIGHT STORAGE LAMINATED: specifications as item no. D 1 above but of heights up to 1200/1350 mm and 400/450 mm deep. Storage to be finished on all sides. Provide two adjustable shelves.				
3	Overhead storage : Laminated	SqM	6		
	OVERHEAD STORAGE LAMINATED: Form as per item D 1 above but of height 1000/1200 mm and hung onto wall. All exposed surfaces faced with 1 mm thick laminate. Storage to include shutters and also open shelves. Laminate as approved. Refer Drawing No : DT-514				
4	Stone Top Counter Storage, Laminated	SqM	7		
	UNDER COUNTER STORAGE: Fabricate and install storage module under RCC counters in toilet and pantry or under worktop counters. Shutters of storage unit to be formed out of 19 mm thick BWP ply and faced with 1 mm thick laminate. Shutters to be hung on concealed hard wood frame out of 50 x 50 section as per details. Provide one shelf, made of 19 mm thick BWP ply, polished to architect's approval. Complete with all necessary fittings like hinges, ball catchers, tower bolts, locks, handles, adjustable shelves etc. as per directions of				

	Architect. Inside surfaces to be finished with 8 mm thick laminate. Cupboard depth of 600- 750 mm.				
5	D.B. Shutter Storage				
	Providing and fixing DB shutters in 25mm thick commercial grade block board finished in approved shade laminate on exposed surface and on the interior surface with approved beading and framework in salwood of section 50mm x 50mm, finished in colour polish matching the colour of the laminate. Rate to be inclusive of providing and fixing of Aluminium Grill finished in approved shade powder coating for ventilation, approved handle, tower bolts, Locks, magnetic ball-catch etc complete as directed. Basic cost of Laminate Rs.50/sft(inclusive of leather finish) Cost to include all necessary hardwares as required and make as specified in the makes sheet, the storages to be provided with two set of master keys.	SqM	5		
D	DOORS				
1	Frameless Glazed : Type D 1				
	FRAMELESS GLAZED DOOR: Providing and fixing 12mm Toughened glass door 2400/2500 mm x 1000 mm. The shutter will be fixed on Geze/ Dorma Patch fitting set inclusive on top and bottom patch, lock set and floor spring. Rates to be inclusive of all necessary hardware fittings including SS handle, lock, stopper and stay as approved by Architect.	Nos	10		
2	Flush Door, Laminated D 03				
	FLUSH DOORS LAMINATED 1000 MM: P&F Semi solid core laminated door formed out of 25X 100 mm wide CPTW frame 6 mm thick ply skins, and faced both sides with 1 mm thick laminate to form overall thickness of 40 mm. 50X 100 section Maplewood chowkhat. All wooden sections to be stained and melamine polished to Architect's approval. All handles to be in brushed SS finish of Dorset or equivalent make and Architect's approved model. Complete with all hardware including locks, door closer, door stoppers etc as required. Overall door size to be 2400 mm x 1000 mm.	Nos	2		
E	PARTITIONS				
1	Frosting Film on Glazed Partitions				
	FROSTING FILM: Provide and apply 3M or equivalent make frosting film, sparkle finish, on glazed partitions doors etc. in patterns as provided by the Architects.	SqM	40		
2	Reception Backdrop Logo				
	Provide & Install Reception Backdrop Logo of approx. size 1800mm x 1200 mm as per Guidelines of "Client" complete in all aspects. Logo to be fabricated in Acrylic Letter Cut finishes with Duco paint as per approved Pantone Shades of Client Guidelines. Proper provision of fixing of Logo on Partition Surface/Glass Surface/Acrylic Surface etc to be considered. There should be no deviation is cost incase of Marginal increase in size of Logo as per look n feel and approval of artwork at later stages.	Nos.	1		

3	History Wall Feature : 2400 mm x 2400mm				
	History Wall : Provide & Install History Wall Feature made of Environmental Graphic Design with Hi resolution images digitally reproduced on 3M self-adhesive changeable, cast imaging film laminated with 3M UV-graphic protective layer. The graphics application to be bubble-free and direct on wall with the help of air-release channels in the adhesive. Must comply with ASTM E-4. 3-year MCS warranty for Interior application on wall components. Basic cost of Graphics Rs.375/sft. Cost to include Base of Graphic to be made in MDF panelling with different level surface In-Out upto +300 from base Wall Surface as per overall composition.	L/S	1		
4	Internal Signages : 300 mm x 200mm				
	Provide and install internal signage for Common Room and Critical Rooms like Server, UPS, Store, AHU, Cabins, Meeting Rooms etc. Signage to be in brushed stainless steel finish with vinyl letter cuts. Size of signage plates to be 200 x 300 x 2 mm.	Nos.	10		
5	Fire Evacuation Route Map : 600 mm x 900mm				
	Provide and install Evacuation Route Map printed on Self Illuminated Photolumicant Sheet as approved.	Nos.	4		
6	Marker Trey				
	MARKER TRAYS: Fabricate and Install marker tray of size 300 mm x 100 mm x 50 mm, fabricated out of 25 mm thick boards faced with 1 mm thick laminate. Conceal mounted on existing partitions, walls etc.	Nos.	5		
7	Roller Blinds				
	ROLLER BLINDS: Supply & Fixing of Roller blinds made up of High Strength Anodized Aluminium alloy Extruded grooved tube. Size: 32 mm outside diameter (+ 2%); weight = 150gms/running mtr.Control Unit with Clutch Mechanism: The control unit is made of high strength reinforced plastic.	SqM	50		
8	Blackout Blinds				
	BLACKOUT BLINDS: Supply & Fixing of Blackout Roller blinds with specification same as above Item but with Opaque Blackout Fabric as provided by Client.	SqM	15		
9	Protection Covering				
	Protection Covering with Polythene : Protecting the existing workstations/ existing assets thick sheet of Vinyl/ polythene good enough strength to be sustain throughout the execution period. Incase of damage to the same, has to be redone and maintained throughout the execution period. Cost to include the removal and disposal of the same away from site at nearest dumpyard available.	L/S	1		
F	FLOOR & WALL FINISHES				
1	Vitrified Tile Flooring - 2'0"x2'0"	SqM	400		

	VITRIFIED TILE FLOORING: Providing and laying vitrified tile flooring of size 600 mm x 600 mm, in locations as directed, laid to required slope in 1: 4 cement coarse sand mortar up to 50 mm thick. With tile grout joints of approved width finished, in colored tile grout, Roff chemicals/ bal or equivalent make.				
2	Ceramic Tile Flooring - 1'0"x1'0"				
	CERAMIC TILE FLOORING: Providing and laying vitrified tile flooring of size 300 mm x 300 mm, in locations as directed, laid to required slope in 1: 4 cement coarse sand mortar up to 50 mm thick. With tile grout joints of approved width finished, in colored tile grout, Roff chemicals/ bal or equivalent make.	SqM	50		
3	P/L Granite Stone Black on stairs	SqM	7		
4	Laminated Parquet Flooring				
	LAMINATED PARQUET FLOORING: Providing & Installation of Laminated parquet flooring of Grade 4, commercial grade, composed of water repellent HDF panels with direct pressure laminate and protective laminate based abrasion resistant film. Thickness of panels to be 11mm including underlay. Rate to include raising of floor level upto 100 mm with base support system of wood deck, underlay, floor transition strips and all accessories as required. Floor to be Pergo as per shade approved. Approved Flooring Shade.	SqM	45		
5	Light Textured Emulsion Paint				
	EMULSION PAINT: Providing and applying plastic light textured emulsion paint to gypsum walls, POP puning, Gypsum ceiling and existing plastered ceiling, including paint putty, base coat as pre manufacturers recommendations and finishing with 2/3 coats of plastic emulsion paint of approved color and make. Surface coating to be achieved as per manufacturer's recommendations for coverage of paint.	SqM	600		
G	FALSE CEILING				
1	Gypsum Board Ceiling				
	GYPSUM BOARD CEILING: Modification in Existing Gypsum & Tile Grid Ceiling to achieve complete office design with or without ceiling concepts in differnet zones.	SqM	250		
2	Tile Grid Ceiling				
	MINERAL FIBRE CEILING Providing and Fixing mineral fibre ceiling consisting of tiles and grids as follows: 1. Fine Fissured or equivalent 0.5 NRC rating, 600 x 600 mm nominal size range or equivalent with tegular edge. 2. Ceiling grid to be of hot dip galvanized steel system, power coated white finish, including main runners, cross tees and wall angles. Profile to be used is 15 mm wide. 3. Main runners to be spaced at 1200mm centers, fixed to soffit by approved hangers at 1200 mm distance. First and last hangers should not be at a distance of more than 450 mm from the adjacent wall. 600 x 600 mm module to be formed by fixing 600 mm cross tee between center of 1200 mm cross tees. Wall angels to be secured to wall at 450mm centers.	SqM	150		

3	Access Panels				
	ACCESS PANEL / TRAP DOOR:- Providing and fixing 600 X 600 MM Knauf Alustar trap door in false ceiling made from stable Aluminium & Knauf moisture resistant Gypsum Board, 12.5mm thick complete as per design and drawing. The rate to be inclusive of Snap Locks 2 pcs.:spring loaded , galvanised steel body & 1 Safety wire.	Nos	5		
4	P/L new UPVC windows as per site with glazing	SqM	36		
5	Reception Table				
6	RECEPTION DESK: Supply and installing reception desk as per architects design. Reception desk to consist of front and side units along with storage units. Front unit to have additional horizontal surface at ht. 1050 mm above the floor level. Entire table to be made of 19 mm thk. commercial board. Front and Sides of Table to be finished in 6 mm thk. Corian of approved colour to Architects approval. Projected front to be finished in 6 mm Thk. corian as per detail in approved colour. Table to have wire management detail, if required. O/A dimensions 1800 x 750 X 1050 MM. One nos. fixed drawer units to consist of two stationary Drawers and one file drawer. All drawers to have 1 mm thk. laminate finished on all sides formed of 19 mm thick board.	Nos	1		
7	P/F LED TVs 42 inches	Nos	3		
	TOTAL				

Sanitary & Plumbing Works					
Sr#	Description	Unit	Total Qty.	Rate	Amount
	SANITARY FIXTURES, FAUCETS & TOILET REQUISITES				
1	Making toilet with all civil work, tiles, plumbing, sanitary fittings etc	No.	1		
2	making pantry and cafeteria plumbing with all sinks, supply drainage etc	No.	1		
	TOTAL for "Sanitary Fixtures, Faucets, & Toilet Requisites " carried over to SUMMARY				
RODENT REPELLENT SYSTEM					
	Supply, Installation OF Rodent Repellent system - Server ,Hub, Electrical, UPS ,Cafeteria	Unit	Rate	Amount	

1	Supply, Installation, Testing and Commissioning of URRS(Ultrasonic Rat/Rodent Repellent System) Master Panel consisting of 10 channel transducer output. The panel shall have display and keypad for setup, separate menu for "test transducer". The panel shall be wall mountable. Make Maser	No		
2	Supply, Installation, Testing and Commissioning of Transducers as per Maser Make Miste . with bracket support	Nos.		
3	Supply and laying of 2 core flexible 14/40 SWG ,specially coated CT cable.	Mtrs		
4	Supply and surface laying of 20 mm dia FRLS PVC Conduit	Mtrs		
	TOTAL			

Sl.No.	Description	Unit	Total Qty.	Rate	Amount
	ACCESS CONTROL SYSTEM				
1	Access Control System Software shall be as per specifications and must be able to work with the 26 bit format with On line time & attendance software with first IN and Last OUT entry 64 reader Lenel License for SWS-ADV	Nos	1		

MODULAR FURNITURE					
S.NO	Particular	SIZE	QTY	Rate	Amount
1	Linear Workstation -25 mm Thick Plpb Top & Base Metal structure 50 x 50 Metal Pipe With Powder Coated & Fabric Screen & Frosted Glass	1050 x 600 x 750	67		
2	Pre-Lam Mobile Pedestal With2 drawer (separate locks for both compartments)	650 x 450 x 450	74		
3	Meeting Table -25 mm Thick Plpb Top & Metal Structure	1500 x 900 x 750 Ht.	1		
4	SG Table -25 mm Thick in Plpb	2400 x 1000 x 750 Ht.	1		
5	Conference Table -25 mm Thick in Plpb	2700x1200x750 ht	1		
6	Manager Tables Set	Nos.	10		
7	Senior Manager Table	1800x900x750	2		
8	Store room Storage in plpb	30	sqm.		
9	Managers Low Ht. modular partitions with writing board	28	sqm.		
10	SG cabin storage units in plpb	18	sqm.		
11	Director Chairs and Conference Chairs	Nos.	28		

	TOTAL				
--	--------------	--	--	--	--

S.NO.	DESCRIPTION	LOCATION	NOS.	Amount
1	Reception Sofa	RECEPTION	5	
2	Center Table	RECEPTION	2	
3	Center Table in SG room and CEO room	both rooms	2	
4	Sofas in SG room and CEO room	both rooms	12	
5	Corner tables in SG room	SG room	2	
6	Sliding folding partition in Conference room with Hettich mechanism	Conference room	1	
7	Printers tables	printers	2	
8	Server room table	server room	1	
9	Rear cabinet in CEO cabin	ceo	1	
10	Lunch Counter in cafeteria	cafeteria	1	
	TOTAL			

CCTV WORKS					
S.NO.	DESCRIPTION	UNIT	QTY	RATE	AMOUNT
1	Supply, Installation, Testing & Commissioning of Indoor Application IP Dome camera with 1.3 MP Resolution, 2.8mm fixed lens, 0.2 lux, Wide dynamic Range, PoE & standard 12VDC/24VAC power input, indoor surface mount enclosure mounted on True Ceiling / False ceiling as per site requirement (including required accessories).	Nos.			
2	S/I/T/C of POE Ethernet Switch with 16 channel port 10/100/1000 Mbps including all accessories	Nos.			
3	Supply, installation, testing and commissioning of 24" TFT Monitor	Nos.			
4	Supply, installation, testing and commissioning of CAT6 Signal Cable	Mts			
5	Supply, installation, testing and commissioning of 25mm FRLS PVC Conduit	Mts			
6	Supply, installation, testing and commissioning of Jack Panel (24V)	Nos.			
7	Supply, installation, testing and commissioning of PATCH CHORD	Nos.			
8	Supply, installation, testing and commissioning of IO	Nos.			
9	Supply, installation, testing and commissioning of Back Box with Faceplate	Nos.			

10	SITC for 6TB HDD storage for CCTV recording	Nos.			
11	DVR and Termination & Commissioning	Lot			
TOTAL					

ELECTRICAL WORKS		
S.No.	Description	Floor Area
1	POINT WIRING	3250
2	DISTRUBITION BOARD	3250
3	SUPPLY & INSTALLATION OF LIGHTING FIXTURES	3250
4	LT CABLES , RACE WAYS , CABEL TRAYS	3250
5	DATA & TELEPHONE WIRING	3250
6	MAIN LT PANEL	3250
	TOTAL COST PER SQ FT	

HVAC LOW SIDE BOQ(if Required)					
S.No	Description	Unit	Qty	Rate	Amount
1.0	Equipments - AC UNITS - COOLING ONLY				
1.1	Supply, Installation, testing and commissioning of Ductable AC as follows:				
	8.5TR Ductable Units - Daikin Make	Nos	3		
	5.0TR Ductable Units - Daikin Make	Nos	1		
1.3	Copper refrigerant piping to interconnect indoor unit and outdoor unit. The refrigerant piping shall be duly insulated with 9 mm think expanded closed cell electrometic polyethylene type insulation.				
	8.5TR Ductable Units - Daikin Make	Rmt	45		
	5.0TR Ductable Units - Daikin Make	Rmt	15		

1.4	Supply and fixing of M.S. angle iron floor mounted frame for outdoor unit.	No.	4		
1.6	Supply, installation, testing and commissioning of 25/32mm PVC drain piping with insulation	Rmt	65		
1.7	Supply, installation, testing and commissioning of control cabling between indoor and outdoor units.	Rmt	100		
2.0	SHEET METAL WORK				
2.1	Supply, installation, repairing of existing duct, testing, balancing & commissioning of the following items as per approved working drawings, specifications and requirement				
	G.S.S square/ rectangular ducting complete with gaskets, elbows, splitters, vanes, supports etc. as per IS- 655/1963 revised till date as required and as per specifications and as per approved shop drawings.				
a	24 gauge	Sqm	240		
b	22 gauge	Sqm	20		
2.2	Supply, installation, testing & commissioning of insulated flexible ducts for supply air diffusers / grilles connection.				
a	250mm dia Insulated Flexible Connection	Rmt	0		
b	200mm dia Insulated Flexible Connection	Rmt	25		
2.3	Fire proof double layered canvass cloth connection for AHU outlet complete with flanges made out of 24G G.S.S sheet on both sides for connection to AHU and duct complete with nuts, bolts etc. as per specification.(if required)	Set	4		
2.4	Supply/replacement & fixing of G.I. construction opposed blade volume control dampers within ducts to be provided with suitable ducts lever and quadrants for manual control of volume of air flow and proper balancing of the air distribution system.	Sqm	2.5		
2.5	Supply, installation, testing and balancing of powder coated extruded aluminum construction supply/ return air Linear Grilles as per approved drawings and specifications.	Sqm	3		

2.6	Modulinear Slot Diffusers:				
	Slot Diffusers In Extruded Aluminum Sections with Vane Air Pattern Controllers including mitred corners & End flanges as shown in the drawings				
	2 Slot Diffuser (5"wide)	RMT	0		
	3 Slot Diffuser (7"wide)	RMT	0		
2.7	Supply, installation, testing and balancing of supply air square shape ceiling Diffusers with removable core & anti smudge ring extruded aluminum construction powder coated as per approved drawings and specifications.	Sqm	5.0		
2.8	Supplying & fixing of opposed blade volume control dampers in supply air duct collars as per approved drawings and specifications.	Sqm	3.0		
3.0	INSULATION				
3.1	Supply, fabrication and installation of acoustic lining of supply and return air ducts as specified and shown on the drawing complete with 10 mm thick acoustic insulation with Open Cell Foam Insulation - Armasound Microban antimicrobial product protection with Thermal conductivity 0.045 W/m deg.K / density 140~180 kg/m3, with manufacturer recommended adhesive SR-505 bonding.	Sqm	20		
3.2	Supply and fixing of external thermal insulation on duct with closed cell nitril insulation of 9 mm thick.	Sqm.	240		
	Total Rs.				

Approved Makes					
Sl. No	Item Description		Approved Brands / Manufacturers	Proposed Make	Proposed Specifications/Model
A	PLUMBING & TOILETS				
	1	Pipes	Tata		
	2	Plumbing Fittings	Jaquar - Continental Series		

	3	Sanitary Fittings	Hindware - PARRYWARE		
	4	Sink	Nirali, Franke		
	5	Bathroom cubicles	Greenlam\Merino		
B	FLOORING				
	1	Vitrified Tiles	Kajaria/ Johnson/ Nitco		
	2	Ceramic Tiles	Kajaria/ Johnson/ Euro / Nitco		
	3	Carpets	Interface / Miliken		
	4	Vinyl Flooring	Armstrong - 2mm		
	5	Laminated Wooden flooring	Armstrong/Ego/Per go		
C	PARTITIONS				
	1	Solid gypsum	India Gypsum Ltd., Gypsteel, USG Boral framework		
	2	Propreitary Al Framework with Glass	NA		
	3	Glass with Wood framework	See individual materials, St Gobain		
	4	Brick Masonry	Class 1 Bricks only		
D	WOOD				
	1	For Door, window and partition frames	Class I Teak Wood only		
E	PLY / BOARDS / LAMINATES / VENEERS				
	1	Commercial Ply wood	IS 303 approved Green Ply / Kitply - 12mm		
	2	Veneers (3 to 4mm and paper veneers)	Greenlam/ Merino		
	3	Laminate 1mm & 1.5mm	Greenlam/ Merino		
	4	MDF	Greenlam/ Merino		
	5	Wood Preservative	Termiseal		
F	CIVIL				
	1	Cement	ACC / Ultra Tech / Grasim		
	2	Adhesives	Pidilite		
	3	Light Weight Concrete Blocks	Siporex		

	4	Waterproofing Compounds	Fosroc / Sika		
	5	Reinf. Steel	Sail / RINL / Tata Steel		
	6	Pest Control Chemical	Godrej		
	7	White Cement	Birla White		
G	GLASS / FILM				
	1	Glass	Saint gobain/Asahi - 10mm (toughened)		
	2	Mirror	Modi guard only		
	3	Frost Film	3M		
H	BLINDS				
	1	Vertical Blinds	Vista/Mac/Hunter Douglas/LIVIN		
I	PAINTS				
	1	Lustre/Enamel Paint	I.C.I. / Asian Paints / Dulux		
	2	Texture Paint	Asian Paint		
	STONES				
	1	Granite			
J	FALSE CEILING				
	1	Gypsum Ceiling	India Gypsum Ltd., Lafarge/ USG Boral		
	2	Grid Ceiling	Armstrong - Dune		
K	MISCELLANEOUS				
	1	Door Closer	DORSET/OZONE		
	2	Insulation material	Nitrile rubber		
	3	Writing Glass	SaintGobain/Asahi - 10mm (toughened)/ Laquered glass		
	4	Floor Spring	OZONE		
	5	Fire Door	Godrej / Ingersol Rand / Signum		
	6	Aluminum Sections	Jindal/Hindalco		
	7	Panic bar	Ingersolrand/Dorma / Vonduprin		
	8	Sun Protective Films	3M		
	9	Door Hardware	Dorma / Geze		
	10	Door Mats	3M		
L	MODULAR				

	1	Workstations, cabin and cubicle furniture, pedestal storages, half height storages, floor mounted and wall mounted storages for cabins etc	Wipro - I am / Godrej - Stallion (Modular Workstations - 5'X5', 5'X2', 4'X2'); cabin/cubicle furniture of Wipro/Godrej/ BP Ergo/ Modular India		
	2	Chairs	Featherlite/ Geeken		
M	FIRE				
	1	Smoke detectors / Heat Detectors / Response Indicator / (Addressable Type)	AGNI		
	2	Manual Call Points	AGNI		
	3	Electronic Hooters	AGNI		
	4	Main & Local Control Panel	AGNI		
	5	M.S Pipes	Tata Steel / Jindal		
	6	Cables	Polycab / CCI / Nicco / Finolex / RPG		
	7	Fire alarm system	AGNI		
	8	Sprinklers	Tyco / Viking		
	9	Sprinkler control valve	Mather & Platt / Viking / HD		
	10	Fire Signages	Prolite - PEL 108 E/M (SM)		
	11	Fire extinguishers	Minimax / Safex / Alert / Zenith / New Age		
N	HVAC				
	1	Cassette split.	Voltas/ Daikin		
	2	Hi wall split.	Voltas /Blue Star / Carrier/Daikin		
	3	Ducting GI Sheets	Sail / Tata / Jindal		
	4	Inline fan	Sodeca / Nicotra / Metrico		
	5	Elastomeric Rubber Insulation	Armaflex / Kflex		
	6	Al powder coated supply air diffusers/Grill	Mahdiartect / Spectra / SS Engg		

	7	Al powder coated return air diffusers/Grill	Mahdiartect / Spectra / SS Engg		
	8	MS box type damper	Mahdiartect / Spectra / SS Engg		
	9	Fire and smoke dampers	CaryAire / Ruskin / Signum		
	10	Fire Damper Actuator	Belimo		
	11	Electrical power and control cabling	Polycab / Finolex		
	12	Vibration Isolator	Flexionics / Kanwal / Resistoflex		
	13	Insulation	Armaflex		
	14	Spiral Ducts			
O	ELECTRICAL				
	1	Low Voltage Switchgear			
	2	Moulded Case Circuit Breakers	Schneider Electric (NS)/ Havell's		
			ABB		
			Siemens (Sentron VL)		
			Ge (RECORD PLUS)		
	3	Miniature Circuit Breakers / Earth leakage Circuit Breakers	Schneider (MG)		
			Siemens/ Havell's		
			Hagger (marketed by L&T)		
			GE Power Controls.		
			MDS Legrand (Lexic range)		
	4	Power & Auxiliary Contractors	ABB		
			Schneider (Telemachanique)		
			Siemens/ Havell's		
			GE Power Controls		
	5	Isolators, Change Over switches	Havells		
			BCH		
			Siemens		
			Schneider		
			ABB		

			Panasonic		
		Battery Banks			
	6		Amar raja		
			Exide		
			Rocket.		
			HBL-Nife		
	7	Cables			
	8	1. Power	CCI		
			NICCO		
			Asian (RPG)		
			Polycab/ Havell's		
			Torrent (LT only)		
			Lapp Kabel		
			Universal		
	9	2. Control	CCI		
			Asian (RPG)		
			Polycab		
			National		
			Finolex/ Havell's		
			Universal		
			R R Kabel		
	10	3. Instrumentation	CII		
			NICCO		
			Asian (RPG)		
			Polycab		
			Lapp Kabel		
			Universal		
			RR Kabel		
	11	4. House wiring	CCI		
			NICCO		
			Asian (RPG)		
			Polycab		
			Finolex/ Havell's		
			National		
			Lapp Kabel		
			RR Kabel		
	12	Lighting systems	Philips/ Wipro/ Thorn/ Havell's		
	13	Modular switches for commercial / residential installations	ABB/Legrand/Anch or Roma/ Havell's		

	14	Terminals	Elmex, Wago, Phoenix		
	15	Surge arrestors (LV and data/communication)	Phoenix, Schneider, Furse, OBE Bettermann		
	16	Analogue and digital metres	Enercon, AE, JMP, ABB, Rishab		
	17	Conduits and accessories	Lapp Kabel, BEC, AKG, Steelcraft		
	18	Cable lugs	Dowells, Jainson		
	19	Cable glands	Baliga, comet, SMI		
	20	Cable jointing and termination kits	Raychem		
			Birla 3M		
			Densons (cold shrink)		
P	DATA Cables		Tyco / AMP		

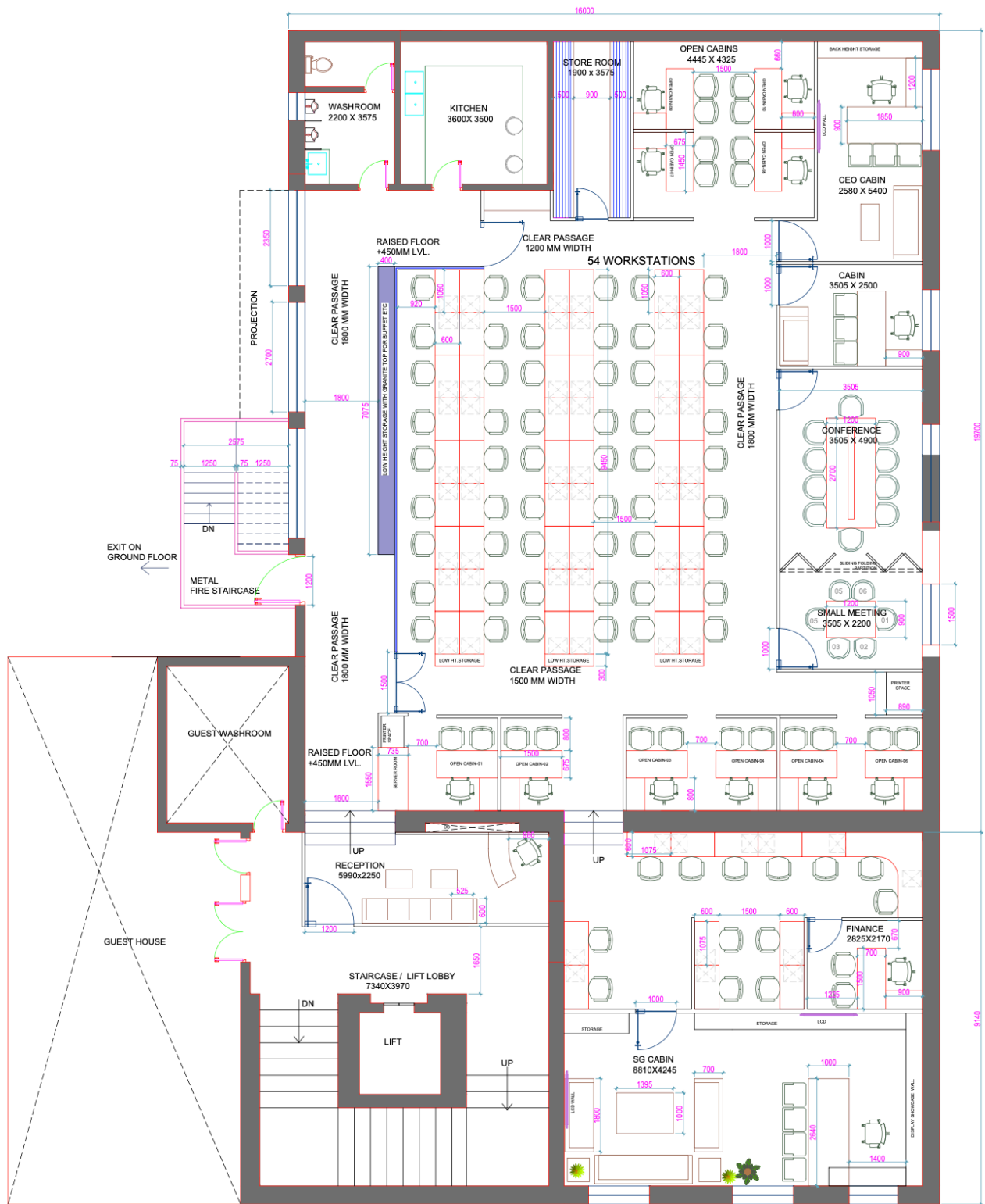

Layout Plan with Dimensions

Form 1: Covering letter with the Proposal in response to RFP Notice

(To be submitted on the Letterhead of the responding firm)

{Place}

{Date}

To,

Deputy Director (Accounts),
Quality Council of India,
Institution of Engineers Building,
2nd Floor, 2, Bahadur Shah Zafar Marg,
New Delhi-110002

Subject: Submission of proposal in response to the RFP for “**Interior and Civil Works at Quality Council of India Head Office**”.

Dear Sir,

1. Having examined the RFP document, we, the undersigned, herewith submit our proposal in response to your RFP dated <dd/mm/yy> for “<RFP Name>”, in full conformity with the said RFP document.
2. We undertake, if our proposal is accepted, to adhere to assign a team dedicate to this project.
3. We have read the provisions of RFP and confirm that these are acceptable to us. We further declare that additional conditions, variations, deviations, if any, found in our proposal shall not be given effect to.
4. We undertake, if our proposal is accepted, to adhere to the scope of engagement or such modified plan as may subsequently be mutually agreed between us and QCI or its appointed representatives.
5. We agree to unconditionally accept all the terms and conditions set out in the RFP document and also agree to abide by this bid response for a maximum period of TWO MONTHS from the date fixed for bid opening and it shall remain binding upon us with full force and virtue, until within this period a formal contract is prepared and executed, this bid response, together with your written acceptance thereof in your notification of award, shall constitute a binding contract between us and QCI.

6. We affirm that the information contained in this proposal or any part thereof, including its exhibits, schedules, and other documents and instruments delivered or to be delivered to through this proposal is true, accurate, and complete.
7. This proposal includes all information necessary to ensure that the statements therein do not in whole or in part mislead the QCI as to any material fact. We agree that QCI is not bound to accept the lowest or any bid response you may receive. We also agree that you reserve the right in absolute sense to reject all or any of the products/ service specified in the bid response without assigning any reason whatsoever.
8. We confirm that we have not been blacklisted by any central or state government agency, PSU etc.

It is hereby confirmed that I/We are entitled to act on behalf of our corporation/company/firm/organization and empowered to sign this document as well as such other documents, which may be required in this connection.

Dated this Day of 2021

(Signature) (In the capacity of)

Duly authorized to sign the Bid Response for and on behalf of:

(Name and Address of Company) Seal/Stamp of Vendor

Form 2: Relevant Project Experience

S. No.	Name of the Project/Engagement	Client name	Duration (Period)	Value

Form 3: Resource Profiles

Using the format provided below, please provide summary information on the team you propose for the project. (Include CVs)

Resource Summary

S. No	Proposed Role	Number of Resources	Area of Expertise	Key Responsibilities

Form 4: Details of Responding Organisation

Section No.	Sr. No.	Particular	Detail
I	COMPANY PROFILE :		
	1.	Name of the Organization * (As appearing on PAN Card)	
	2.	Registered Office Address *	
	3.	Address for Billing Office & Address *	
		Name of Contact Person *	
		Contact No. *	
		Mobile No.	
		E mail ID *	
	4.	Name of Contact Person (Finance & Accounts) *	
		Contact no.	
		Mobile no.	
		E mail ID *	

II	STATUTORY DETAILS:		
	1.	GST Details: -	
		Whether Registered Assessee (Yes or No)	
		If Yes: -	
		GSTIN Number # *	
		Type of Assessee	
	2.	MSME	
		Whether Registered under MSME (Yes or No) *	
		If Yes: -	
		MSME Registration No. and validity date # *	

	3.	Permanent Income Tax No. (PAN) #	
	4.	<u>NATURE OF ENTITY: *</u> PROPRIETOR/PARTNERSHIP/ LPP/ PRIVATE LIMITED /PUBLIC LIMITED/GOVERNMENT	
	5.	WHETHER FUNCTIONING IN A SPECIAL ECONOMIC ZONE. (SEZ) (YES/ NO) *	

III	BANK DETAILS: -		
		Name of Bank	
		Address of Bank	
		Bank Account No.	
		IFSC Code	
		SWIFT CODE (If party's billing address is outside India)	

IV	Details of responding Company		
1.	Current Year Turnover (Rs Crores) from application development and audit related operations in India;		
2.	Company Profile (Operations in India)		
2.1	Average turnover from Indian Operations	(Turnover in Rs Crores)	
2.2	Full-time professional staff engaged in related services	(Number of Staff)	

2.3	Extent of operations in India (national spread) i.e. number of offices in India (client specific / project specific offices should not be taken into account)	(Number of Offices in different cities/towns and their address)	
3.	Company Experience		
3.2	Experience of working on similar Specifications		(Number of Projects and their brief description)

Declaration by Director/ Proprietor/ Partner:

I/We declare that the information furnished above are correct to the best of my/our knowledge / belief. I/We undertake to inform you of any change in above particulars at the earliest.